



## 16 Wrens Gate

Plymstock, Plymouth, PL9 7BQ

**£750 PCM**



Semi-detached house offering unfurnished accommodation for long-term rental including fitted kitchen, lounge/diner, 2 bedrooms & bathroom. Garage & driveway. Enclosed garden to the rear. Strictly no pets or smoking.



16 WRENS GATE, PLYMSTOCK, PLYMOUTH, PL9 7BQ

ACCOMMODATION

Doorway leading into the entrance porch.

ENTRANCE PORCH

Double-glazed windows to the side elevation. Tiled floor. Doorway leading into the entrance hallway.

ENTRANCE HALLWAY

Stairs rising to the first floor accommodation. Under-stairs storage cupboard. Laminate flooring. Doorway leading into the kitchen.

KITCHEN 9'8" x 7'5" (2.96 x 2.27)

Matching eye-level and base units. Built-in cooker. Inset sink unit. Space for washing machine. Laminate flooring. Double-glazed window to the front elevation.

LOUNGE/DINING ROOM 13'7" x 10'6" (4.16 x 3.22)

Double-glazed window to the rear elevation. Door leading onto the rear garden.

FIRST FLOOR LANDING

Loft hatch. Doors leading to the first floor accommodation.

BEDROOM ONE 11'1" x 10'4" (3.38 x 3.15)

Built-in wardrobe. Built-in cupboard housing the boiler. Range of fitted bedroom furniture including full-length wardrobe and bedside units. Double-glazed window to the front elevation.

BEDROOM TWO 6'11" x 6'0" (2.12 x 1.85)

Double-glazed window to the rear elevation.

BATHROOM

Coloured suite comprising panelled bath with shower unit and spray attachment, sink and low-level wc. Double-glazed window to the rear elevation.

OUTSIDE

Tarmac drive. Garage with up-and-over door to the front. Power and light. Door leading to the rear garden. There is a paved area adjacent to the rear of the house with a lawn and planted garden beyond. The rear garden is sloped and enclosed by timber fencing.

Area Map



Floor Plans

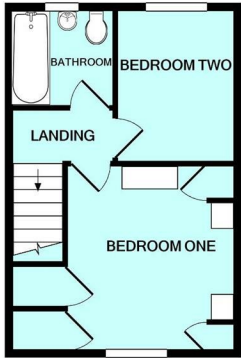

Energy Efficiency Graph

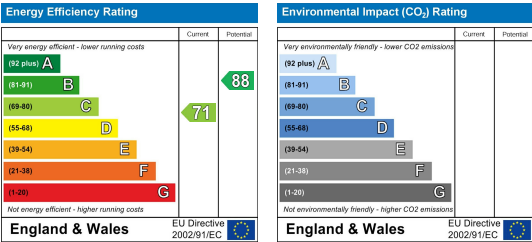

These particulars, whilst believed to be accurate are set out as a general outline only for guidance and do not constitute any part of an offer or contract. Intending purchasers should not rely on them as statements of representation of fact, but must satisfy themselves by inspection or otherwise as to their accuracy. No person in this firms employment has the authority to make or give any representation or warranty in respect of the property.